

NEW TRANSPORTATION FACILITY PROPOSED SITE PLAN

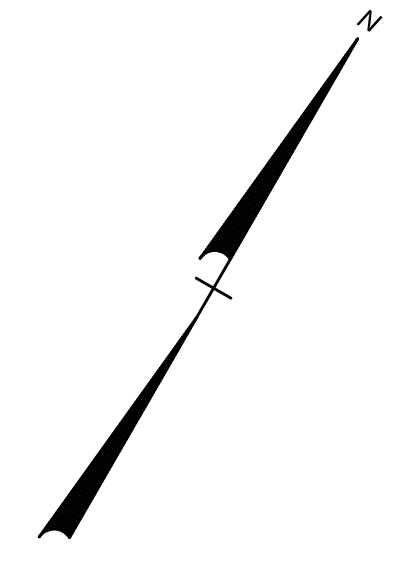

- LEGEND**
- Square Catch Basin
 - Flow Direction
 - Manhole
 - Utility Pole
 - Guy Anchor
 - ⊥ Single Post Sign
 - ⊥ Double Post Sign
 - ▲ Highway Monument
 - Centerline
 - Property Line
 - 59.32-1-3.211 Tax Parcel Number
 - ☼ Coniferous Tree
 - Deciduous Tree
 - Shrub
 - ⊥ Stump

- NOTES**
1. Underground utilities shown are from field location if possible. Others are shown from available record data, their exact location may be different from that as shown and others may exist. As always it is the contractor's responsibility to notify Dig Safety - New York at (800) 962-7862 prior to any excavation.
 2. The site survey was performed November 2022.
 3. The horizontal datum for this survey is based on NYS East Zone NAD83(2011) (North American Datum 1983/2011).
 4. The vertical datum for this survey is based on the North American Vertical Datum of 1988 (NAVD88).

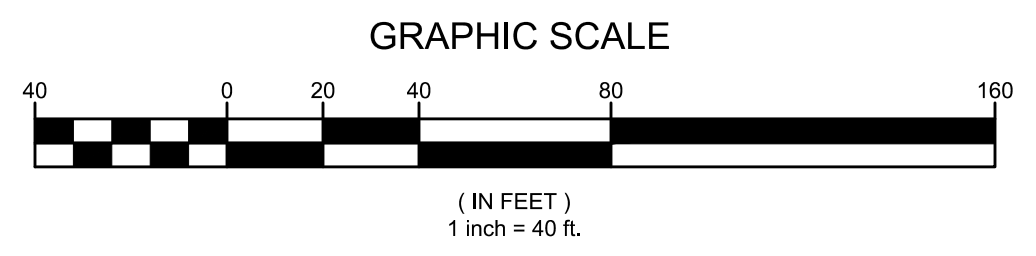
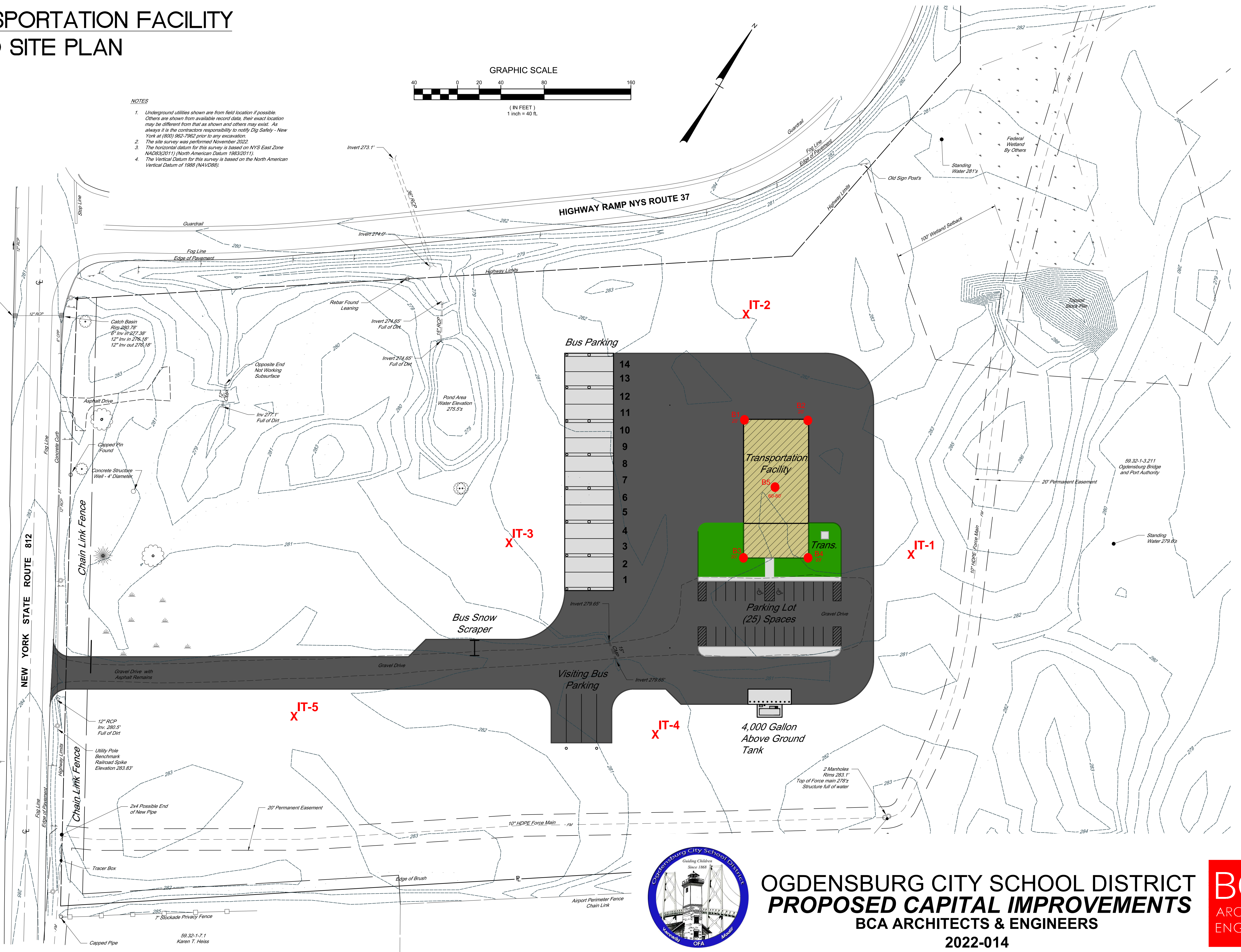

OGDENSBURG CITY SCHOOL DISTRICT
PROPOSED CAPITAL IMPROVEMENTS
 BCA ARCHITECTS & ENGINEERS
 2022-014



01/2023 - Location: 117 Prospect Street, Ogdensburg, NY 13623
 01/2023 - Location: 117 Prospect Street, Ogdensburg, NY 13623
 01/2023 - Location: 117 Prospect Street, Ogdensburg, NY 13623